



## FRIFRI PROFI 6 + 6 ELECTRIC COUNTER-TOP TWIN TANK FRYER - 2 BASKETS - W 540 MM - 2 X 4.6 KW

# MODEL: 650950



Fry delicious food precisely with the powerful FriFri 4.6kW Profi+ 6 + 6 Counter Top Twin Tank Fryer. Sturdy and safe, the fryer's stainless steel tank has the capacity to produce 28kg of perfectly fried chips per hour, while there's also a rear-mounted slot-in lid that also acts as a splashback and basket support. The dual independently controlled tanks mean you can quickly cook deliciously crispy fish, chips or chicken without any flavour transfer between tanks. The Profi+6 + 6 boasts the kind of quality that customers have come to expect from the FriFri brand for over 70 years.

A/A FILE NUMBER:

### PRODUCT OPTIONS AND ACCESSORIES

- FZ300716 BASKET FOR PROFI/FRITA+ 6/10 AND PROFI+ 10 - WITHOUT HANDLE

### PRODUCT FEATURES

- A powerful counter top fryer capable of producing 28 Kg of chips per hour
- Highly responsive digital electronic control able to maintain oil to +/-1 °C of the temperature selected
- Enhanced operator safety with front mounted control panel
- Rear-mounted slot-in lid that also acts as a splashback and basket support
- Safe and easy to use front valve for draining off used oil
- One piece pressed stainless steel tank with rounded corners for increased durability and reduced cleaning times

ITEM NUMBER:



# FRIFRI PROFI 6 + 6 ELECTRIC COUNTER-TOP TWIN TANK FRYER - 2 BASKETS - W 540 MM - 2 X 4.6 KW

## MODEL: 650950

### WEIGHTS & DIMENSIONS

|        |         |
|--------|---------|
| Width  | 270 mm  |
| Depth  | 475 mm  |
| Height | 455 mm  |
| Weight | 12.6 kg |

### SHIPPING DETAILS

|                            |                         |
|----------------------------|-------------------------|
| Ship Width                 | 61 cm                   |
| Ship Depth                 | 32 cm                   |
| Ship Height                | 38 cm                   |
| Ship Weight                | 14 kg                   |
| Number of Shipment Parcels | 1                       |
| Shipping Origin Zip Code   | LN6 3QZ, UNITED KINGDOM |
| Quick Ship Product         | No                      |
| Returnable Item            | No                      |

### PRODUCT CERTIFICATIONS



### ENERGY SPECS

|                            |                                       |                                      |                  |
|----------------------------|---------------------------------------|--------------------------------------|------------------|
| Primary Energy Source Type | Electricity                           | Number of Electrical Conductor Wires | 2                |
| Electrical Amps            | L1=2 x 6.7; L2=2 x 6.7;<br>L3=2 x 6.7 | Electrical Connection Type           | Direct Hardwired |
| Electrical Voltage         | 400 volts                             | Electrical Plug Type                 | Hardwired        |
| Electrical Watts           | 2 x 4,600                             | Number of Electrical Plugs           | Not Applicable   |
| Electrical Phase           | Three                                 | Dedicated Circuit Required           | Yes              |
| Kilowatts                  | 9.2 kW                                | Energy Saving                        | No               |

### ADDITIONAL SPECIFICATIONS

|                            |                                  |                             |            |
|----------------------------|----------------------------------|-----------------------------|------------|
| Auto Oil Top-Off           | No                               | Total Oil Capacity (volume) | 14 l       |
| Basket Lift Type           | Not Applicable                   | Oil Reclamation             | No         |
| Control Type               | Rotary Control Knob              | Oil Temperature Control     | Electronic |
| Food Production Rate       | 2 x 14kg fries - 7mm<br>[frozen] | Pumped Oil Filtration       | No         |
| Fryer Type                 | Open Pot                         | Split Pot                   | Yes        |
| Integrated Filtration      | No                               | Temperature Maximum         | 190 °C     |
| Number of Baskets          | 2                                | Temperature Minimum         | 150 °C     |
| Number of Burners          | Not Applicable                   | Vat 1 Oil Capacity (volume) | 7 l        |
| Number of Vats (batteries) | 2                                | Vat 2 Oil Capacity (volume) | 7 l        |

Frifri reserves the right to modify specifications or discontinue models without incurring obligation. Dimensions nominal.

Document Auto-Generated  
January 23, 2024





**FRIFRI PROFI 6 + 6 ELECTRIC COUNTER-TOP TWIN TANK FRYER - 2  
BASKETS - W 540 MM - 2 X 4.6 KW**

**MODEL: 650950**

**BIDDING SPECIFICATIONS**

Bidding Specifications Not Available.

**TECHNICAL DRAWING**

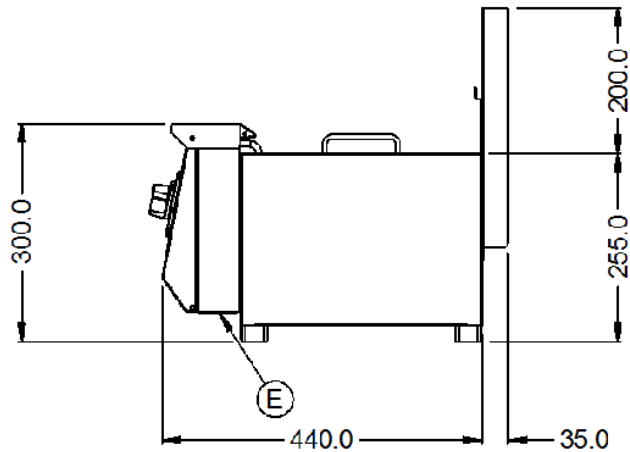
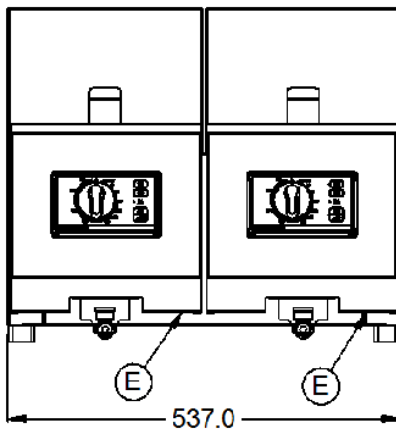
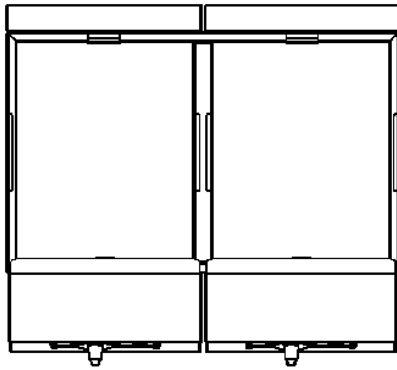

Frifri reserves the right to modify specifications or discontinue models without incurring obligation. Dimensions nominal.

Document Auto-Generated  
January 23, 2024

