



## FRIFRI PROFI 10 ELECTRIC COUNTER-TOP SINGLE TANK FRYER - 2 BASKETS - W 540 MM - 6.9 KW

# MODEL: 651068



profi+

Fry delicious food precisely with the powerful FriFri 6.9kW Profi+ 10 Counter Top Fryer. Sturdy and safe, the fryer's stainless steel tank has the capacity to produce 20kg of perfectly fried chips per hour, while there's also a rear-mounted slot-in lid that also acts as a splashback and basket support. The Profi+ 10 boasts the kind of quality that customers have come to expect from the FriFri brand for over 70 years.

AIA FILE NUMBER:

### PRODUCT OPTIONS AND ACCESSORIES

- FZ300716 BASKET FOR PROFI/FRITA+ 6/10 AND PROFI+ 10 - WITHOUT HANDLE

### PRODUCT FEATURES

- A powerful counter top fryer capable of producing 20 Kg of chips per hour
- Highly responsive digital electronic control able to maintain oil to +/-1 °C of the temperature selected
- Enhanced operator safety with front mounted control panel
- Rear-mounted slot-in lid that also acts as a splashback and basket support
- Safe and easy to use front valve for draining off used oil
- One piece pressed stainless steel tank with rounded corners for increased durability and reduced cleaning times

ITEM NUMBER:



# FRIFRI PROFI 10 ELECTRIC COUNTER-TOP SINGLE TANK FRYER - 2 BASKETS - W 540 MM - 6.9 KW

## MODEL: 651068

### WEIGHTS & DIMENSIONS

Width	720 mm
Depth	475 mm
Height	455 mm
Weight	28 kg

### SHIPPING DETAILS

Ship Width	74 cm
Ship Depth	54 cm
Ship Height	36 cm
Ship Weight	30.8 kg
Number of Shipment Parcels	1
Ship Method	Small Parcel (FedEx, UPS, DHL)
Shipping Package Type	Pieces
Shipping Origin Zip Code	LN6 3QZ, UNITED KINGDOM
Quick Ship Product	No

### PRODUCT CERTIFICATIONS



### ENERGY SPECS

Primary Energy Type	Electric	Electrical Phase	3-Phase
Electrical Amps Per Conductor	L1=10.0; L2=10.0; L3=10.0	Electrical Plug Type	Hardwired
Electrical Total Amperage	30 A	Number of Electrical Plugs	Not Applicable
Electrical Volts	400V	Electrical Connection Type	Direct Hardwired
Electrical Total Wattage	6900 W	Number of Electrical Conductor Wires	1
Electrical Kilowatts	6.9 kW	Dedicated Circuit Required	Yes
		Electrical Remarks	Three

### ADDITIONAL SPECIFICATIONS

Auto Oil Top-Off	No	Number of Vats (batteries)	1
Basket Lift Type	Not Applicable	Total Oil Capacity (volume)	30 l
Construction Materials	Stainless Steel	Oil Reclamation	No
Control Type	Rotary Control Knob	Oil Temperature Control	Electronic
Food Production Rate	20kg fries - 7mm [frozen]	Pumped Oil Filtration	No
Fryer Type	Open Pot	Vat 1 Oil Capacity (volume)	30 l
Integrated Filtration	No	Ventless Cooking Technology	No
Number of Baskets	1	Split Pot	No
		Temperature Maximum	190 °C

Frifri reserves the right to modify specifications or discontinue models without incurring obligation. Dimensions nominal.

Document Auto-Generated  
January 09, 2025





FRIFRI PROFI 10 ELECTRIC COUNTER-TOP SINGLE TANK FRYER - 2  
BASKETS - W 540 MM - 6.9 KW

MODEL: 651068

**BIDDING SPECIFICATIONS**

Bidding Specifications Not Available.

**TECHNICAL DRAWING**

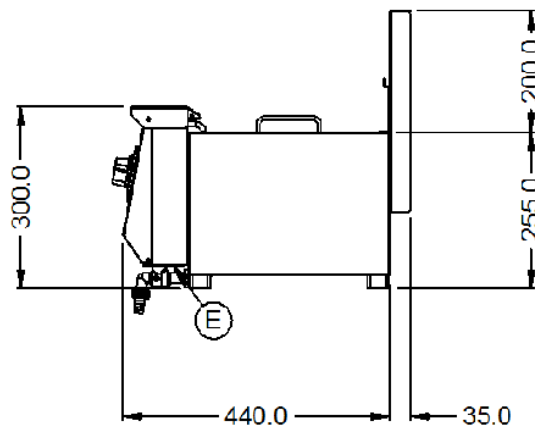
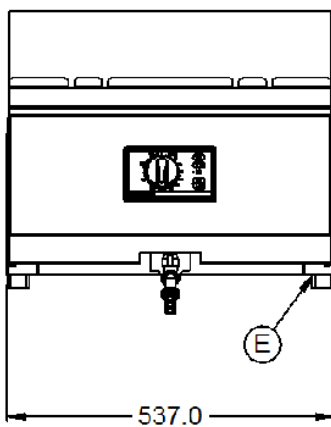
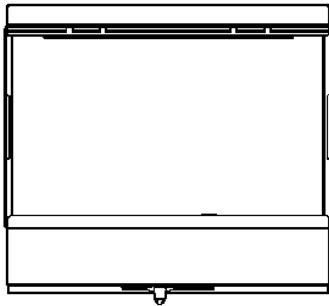

FriFri reserves the right to modify specifications or discontinue models without incurring obligation. Dimensions nominal.

Document Auto-Generated  
January 09, 2025

